

**BOX CONTENTS:**

- 1 camera
- 1 monitor
- 2 power adapters
- 1 screw , 1 plug en 2 cable binders
- This user manual
- WIFI/APP pairing quickstart manual

PRODUCT LAYOUT**Camera (Fig. 1)**

1. Light sensor
2. Microphone
3. Lens
4. Infrared LEDs
5. Speaker
6. Power adapter plug
7. Pairing button (to connect the camera to the router)
8. Antenna
9. Temperature sensor
10. Power indicator LED

Monitor (Fig. 2)

1. LCD screen
2. Volume indicator LEDs
3. VOX indicator LED
4. Power indicator LED
5. Volume up button
6. Volume down button
7. Microphone
8. Power ON/OFF switch
9. Antenna
10. Menu button
11. Talkback button
12. Speaker
13. Power adapter plug

SETUP**1. CAMERA EN MONITOR SETUP****1.1 Power supply camera**

Plug one end of the provided power adapter into a wall outlet and the other end into the back of the camera. Camera automatically turns on when plugged in(see Fig. 3).

NOTE: Use the adapter labelled OUTPUT: 5V DC 2.0A for the camera.

1.2 Placing the camera

Place the camera in a convenient location, point the lens toward the observation area.

NOTE: Don't turn the camera manually! Rotating the camera head should only be done through the menu of the monitor(see Fig 11).

1.3 Night vision

The camera is equipped with 8 high-intensity LEDs to create clear images in the dark. When the light sensor detects low ambient light levels, the LEDs are automatically activated.

1.4 Room temperature measurement

The temperature sensor measures the room temperature on the camera side, the temperature will be displayed on the screen of the monitor.

1.5 Power supply monitor

The monitor has a built in 3.7V 2600mAh (Li-ion) battery and uses household AC power current.

1. Plug one end of the provided power adapter into a wall outlet and the other end into the monitor (see Fig. 4).
2. Slide the power switch to 'ON' (see Fig. 4).

NOTE 1: Use the adapter labelled OUTPUT: 5V DC 1.0A for the monitor.

NOTE 2: When there is power on the monitor, the "Power" LED will light up green. When the battery is low, the "Power" LED will start blinking red.

When the battery is charging, the "Power" LED will be continually red.

Once the battery is fully charged, the "Power" LED will turn off (if the monitor is turned off)

NOTE 3: (🔋) X (📶) (out of range) will be displayed on the LCD screen if the monitor and camera are too far apart.

2. MONITOR BUTTONS**2.1 Volume setting**

Press volume up or volume down (🔊) & (🔇) to adjust the volume level. (see Fig. 5)

2.2 Talkback function

Press and hold the talk back button (🗨️) to speak through the camera unit, the 🗨️ icon will be displayed on the screen (see Fig. 6)

3. TOUCH SCREEN MENU OPTIONS

- Tap the screen and the touch screen menu will be displayed on the right side of your screen (see Fig. 7).
- Tap on the menu function you wish to adjust to select it.
NOTE: Touch screen settings need to be completed within 5 seconds. After 5 seconds the screen will return to live view automatically.

3.1 Sound only mode

Tap the  icon to activate the sound only mode. The video feed will then be turned off after 10 seconds, the sound stay on. When you touch the screen the screen will be activated for 15 seconds. (see Fig. 8)

3.2 Zoom function

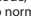

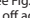

Tap the zoom  icon once to enter zoom mode, the screen will display 2x zoom image, tap the zoom  icon again to return to normal (non-zoomed) view (see Fig. 9).

3.3 Music Function

You can play 3 different lullabies with the camera.

- Tap the music  icon on your screen and choose the song you want to be played on the camera (see Fig. 10).
- To turn the music off again tap the music  icon again and select the bottom option (see Fig. 10).

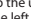
3.4 Camera Pan/Tilt remote control function





On the monitor you can remotely control the camera. The camera head has the ability to rotate up, down, right and left. Tap the up  or down  icons on your screen to move the camera up or down. Tap the left  or right  icons on your screen to move the camera to the left or right (see Fig. 11).

NOTE: The monitor will be in silent mode when the camera rotates.

4. MENU OPTIONS

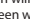
- Press the menu button  on top of the monitor to display the main menu on the screen.
- The main menu contains 3 submenus (see Fig. 12).

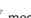
4.1 VOX-function (Activating the monitor by sound)

- Select VOX  in the menu of the monitor. Here you can activate the VOX mode, when 'ON' is selected the VOX mode is active and when 'OFF' is selected the VOX mode is not active. When VOX mode is active the screen will automatically turn off after 10 seconds, the VOX-LED  on the side of the screen will then light up (see Fig. 13).
- When the sound level near the camera reaches the pre-set level (see Fig. 13), the screen will automatically re-activate. After 20 seconds the screen will automatically turn off again.
- The VOX-Sensitivity can be set to three different levels, high , medium  and low , the higher the sensitivity the lower the sound level needs to be at the camera side for the monitor to activate.

4.2 Brightness settings

To adjust the screens brightness you select the  icon in the menu, here you can make the screen brighter by tapping + or darker by tapping the - (see Fig. 14).

4.3 Temperature settings

- Select the temperature settings submenu  in the menu screen, here you can choose if you want the temperature to be displayed in Celsius or Fahrenheit (see Fig. 15).
- You can also set the temperature range for the temperature alert. If you select "Alert On" to activate the temperature alert, a warning sound will be emitted by the monitor unit when the measured temperature is outside the pre-set parameters. (See Fig. 15).

5. STATUS INFORMATION

The status bar will be displayed on the top of the screen (See Fig. 16).

- Signal strength indicator
- Temperature alert on/off indicator
- Room temperature indicator
- Zoom in indicator
- Audio only mode indicator
- Music indicator
- Mute indicator
- Talkback indicator
- Battery status / charging indicator

6. TELEPHONE/TABLET SETUP

6.1 Check up on your baby anytime and anywhere you want!

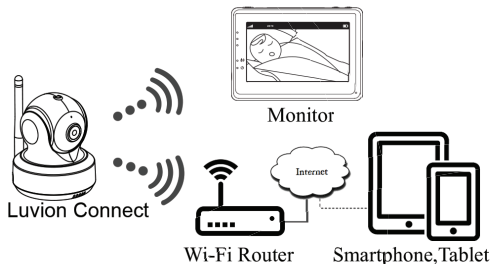

6.2 Before you start you need



iPhone, iPad,
Android smartphone
or Android tablet



Luvion Connect



Wi-Fi Router

6.3 Download and run the Luvion Connect app

Android: Go to the Google Play Store and search for 'Luvion Connect' and install.

iOS: Go to the App Store and search for 'Luvion Connect' and install.



QR ANDROID

QR iOS

6.4 Add and connect camera wirelessly to your router

1. Tap the  icon to add the camera. Tap the icon above 'connecting camera to the internet' (see A1 on the next page).

2. Plug one end of the provided power adapter into a wall outlet and the other end into the camera.

3. The camera will automatically turn on after connecting the power adapter, after 30 seconds the camera will be ready.

4. Tap  to go to the next step (see A2 on the next page).

Press and hold the PAIR button on the camera until the LED indicator light start blinking in green (+ 5 seconds).

5. Tap  to go to the next step (see A3 on the next page).

NOTE 1: If your monitor is on, the monitor will disconnect and reconnect in approximately 5 seconds.

NOTE 2: If the camera was registered to your app previously, the new pairing will overwrite the previous registration.

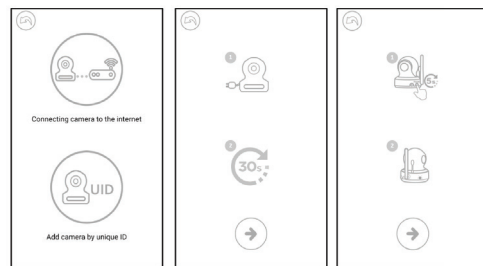

A1

A2

A3

6. **Android:** The app will automatically search for the camera.

iOS: a. Press the 'home button' on your phone and go to 'settings' 

b. Go to 'Wi-Fi' (If Wi-Fi is turned off, please turn it back on).

c. Tap on the name of the camera 'LuvionConnect-XXXXXX' in your Wi-Fi list.

d. After the camera is connected, please return to the LuvionConnect app. (Also see A4)

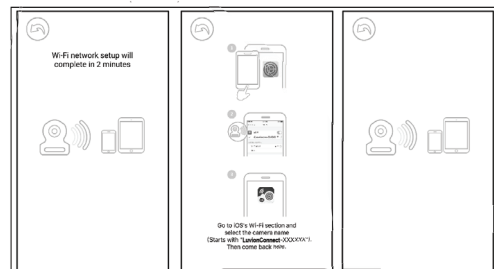

A4

7. The app/camera will scan all available Wi-Fi networks within range. Select your home Wi-Fi network and enter the correct password for this Wi-Fi network. See A5 on the next page.

NOTE: Please make sure you enter the correct password for the Wi-Fi network otherwise a connection error may occur.

NOTE 2: It can take a few minutes before the camera is connected to your Wi-Fi network.

8. In the app you will now see the new camera added to the list, tap the camera here to start watching the live video feed. (see A7)

NOTE: If your monitor is on during this process, the monitor will disconnect from the camera and automatically reconnect in around 10 seconds.

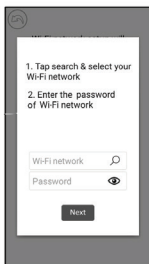

A5

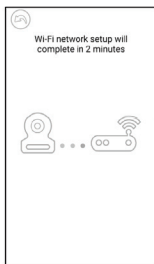

A6



A7

6.5 Start screen app (see A8)

1. Camera name
2. Connection status
3. Settings menu
4. Refreshing the screen
5. Close the app
6. Add camera
7. App information

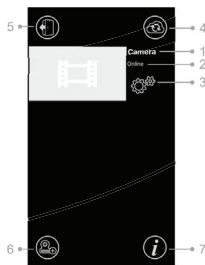

A8

6.6 Live video screen functions (see A9)

1. **Back:** Tap the back icon to go back to the start screen.
2. **Temperature measurement:** The temperature will be displayed here, below the live view.
3. **Photo:** Tap the photo icon to take a picture and save it to your smartphone/tablet.
4. **Video:** Tap the video icon to start/stop a video recording. (each video recording can be a maximum of 3 minutes)
5. **Photos and videos will be stored on the internal memory of your smartphone or tablet.**
6. **Photo/video album:** Tap the map icon to view and manage your videos/photos. To remove photos/videos on android devices tap and hold the photo/video, on iOS you press edit at the top of the screen.
7. **Volume:** Tap the speaker icon to adjust the volume.
8. **Pan/Tilt remote control:** Tap the up ▲, down ▼, left ◀ and right ▶ icons to rotate the camera.

9. **Talk back:** Tap the icon once to activate talk back toward the camera. Tap again to close the talk back connection.

NOTE: While talk back is activated the sounds from the camera side won't be available in the app.

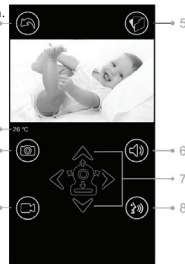

A9

6.7 The app settings menu functions

Tap the setting icon ⚙️ on the start screen (see A7)

1. **Name:** Camera name, tap the ✎ icon to change the name of the camera.
2. **Password:** Enter the correct password to access the camera.
3. **UID:** Each camera has a unique ID(UID). By sharing this UID code and your password you can share the video feed.
4. **Temperature:** Tap the switch 🟢/🔴 icon to switch between Celsius and Fahrenheit. The value that is shown on the switch is currently selected.
5. **Notifications:** Tap the switch 🟢/🔴 icon next to 'Sound' and 'Temp' to activate or deactivate push notifications based on sound and/or temperature. If active you will receive a push notification from the app when the sound or temperature reaches the level that you have set on the monitor.
6. **Delete camera:** Tap the bin 🗑 icon to remove the camera from the app.
7. **Change password:** Tap the lock 🔒 icon to change the password. This icon will only be available when your phone is connected to the same network as the camera. The default password is '12345678', change the default password when you first use the camera!

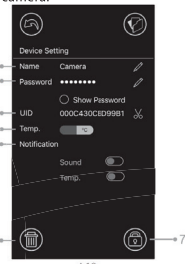

A10

6.8 LED indicator (camera)

Indication	Status
Blinking Green	Camera is ready for pairing
Solid Green	Camera is linked to the Internet
Solid Orange	Lost connection to the Internet
Solid Red	Lost connection to the Wi-Fi router (refer to troubleshooting 7.5)

7 TROUBLESHOOTING

7.1 No video on the monitor

- Make sure the camera's power plug is pushed all the way in.
- Make sure the monitor has enough battery power and is turned on.
- Restart your camera, please unplug the power adapter and reconnect. The will reboot and restart within 25 seconds.
- If the power indication LED is on but only the audio can be heard, the sound only or VOX mode could be active. Press the menu button to turn the screen back on. For instructions to turn these functions off please check section 3.1 (Sound only) or 4.1 (VOX) of this manual.

7.2 (Noise) Interference on your monitor

- Make sure there is at least a 5 feet (1.5m) distance between the camera and other 2.4GHz products, such as Wi-Fi routers, Bluetooth devices or microwave ovens.
- When a microwave or oven is in a direct line between the camera and monitor this can negatively influence the signal strength. To solve this make sure the device is no longer in a direct line between the camera and the monitor or turn it off.
- Make sure the camera and the monitor are within range of each other (The range is maximum 300 meters in open field or around 50 meters inside a house).

7.3 Camera has no connection with the app

- **Timeout:** Make sure your smartphone or tablet is connected to a Wi-Fi router or 4G network.
- **Offline:** Make sure the camera is on and connected to the internet.

7.4 Video problems inside the app

- **No video play:** Please check the camera status on the app's start screen.
- **Video streaming is not smooth:** The video performance is related to your internet bandwidth and possible interference.

7.5 The camera's LED indicator stays solid red

The camera has failed to connect to the Wi-Fi router or the connection was lost.

- Please make sure your Wi-Fi router is working correctly and then restart your camera, please unplug the power adapter and reconnect.
- Make sure the camera is paired with your Wi-Fi router with the correct password for the Wi-Fi router. If you are not sure, please delete the camera from the app and follow the steps from section 6.4 of this manual again.
- Please make sure the camera is within Wi-Fi range. Please move the camera closer to the Wi-Fi router and try again.

7.6 Forgot your password (app)

- Please delete camera from the start screen list and proceed the steps from section 6.4 of this manual again.

CARE AND MAINTENANCE

- Keep all parts and accessories out of children's reach.
- Fingerprints or dirt on the lens surface can adversely affect camera performance. Avoid touching the lens surface with your fingers.
- Avoid touching the lens surface with your fingers.
- Use a soft, dry cloth to wipe off the lens.
- Keep the camera dry. Precipitation, humidity and other liquids contain minerals that will corrode electronic circuits.
- Do not use or store in dusty, dirty areas.
- Do not store in hot areas. High temperature can shorten the life of electronic devices and warp or melt certain plastics.
- Do not store in very cold areas. When the system warms up (to its normal temperature), moisture can form inside the case, this could damage the electronic circuit boards.
- Do not attempt to open the case! Non-expert handling of the device may damage the system and the warranty is voided.
- Avoid dropping or strong shocks
- Use this product only with the included power adapters or provided as an accessory.
- Do not overload electrical outlets or extension cords this can result in fire or electric shock
- The system operates on 2.4 GHz.

SAFETY PRECAUTIONS

Follow these safety precautions to avoid injuries associated with baby monitor cords:

- Make sure the baby unit and AC adapter cords are always out of reach from the baby, at least 3 feet (1 meter) away.
- **Note:** It's important even if your baby is not yet standing or mobile.
- Never place the camera or cables inside the baby's bed.

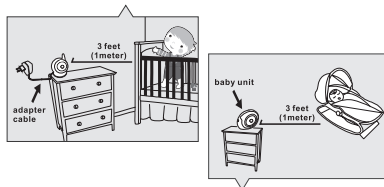

- Make sure the adapter cords are safely tucked away. Bundle long wires using tape or cable clips.
- Use a wireless baby monitor to avoid risk of strangulation.
- Never use extension cords with AC adapters. Only use the AC adapters provided.

General safety precautions:

- Read the user manual carefully and follow the instructions.
- Keep the manual for future reference.
- Please ensure the heat can dissipate easily; never cover the baby-unit, parent unit and/or power adapter.
- Make sure the wires can't get damaged and make sure you can't be tripped by them.
- Keep small parts out of children's reach.
- This product is not a toy, don't let children play with it.
- This baby monitor is not a replacement for parental oversight.
- Don't use the monitor in close proximity to water.
- Test this baby monitor and all its functions before use, to ensure you are familiar with all its functions.
- Never touch the power contact points with sharp or metal objects.

SPECIFICATIONS

Camera		Monitor	
Frequency	2.4 GHz	Frequency	2.4 GHz
Image Sensor	CMOS image sensor	Display	4.3" TFT LCD touch screen
Lens	f 2.8mm, F 2.0	Display colors	Full-color
IR LED	8 pcs	Brightness Control	8 levels
Dimensions	85(W) x 110(H) x 100(D) mm	V.O.X	Voice activation, Audio mode
Weight	223g	Dimensions	128(W) x 90(H) x 45(D) mm
Power Adapter	Input: 100-240V AC, 50/60Hz, 0.5A Output: 5.0V DC, 2.0A	Weight	209g
Operating temperature	0°C - 40°C (32°F - 104°F)	Power Adapter	Input: 100-240V-0.2A, 50/60Hz 12-16VA Output: 5.0V DC, 1.0A
		Battery Capability	3.7V, 2600mAh (Li-ion)
		Operating temperature	0°C - 40°C (32°F - 104°F)

Specifications subject to change without prior notice

This item is in compliance with the essential requirements and other relevant provisions of Directive 2014/53/EU.

* iPhone, iPad are trademarks of Apple Inc.
* Google Play is a trademark of Google Inc.



This device is for indoor use only

FCC Statement

This equipment has been tested and found to comply with the limits for a Class B digital device, pursuant to Part 15 of the FCC Rules. These limits are designed to provide reasonable protection against harmful interference in a residential installation. This equipment generates, uses and can radiate radio frequency energy and, if not installed and used in accordance with the instructions, may cause harmful interference to radio communications. However, there is no guarantee that interference will not occur in a particular installation. If this equipment does cause harmful interference to radio or television reception, which can be determined by turning the equipment off and on, the user is encouraged to try to correct the interference by one or more of the following measures:

- Reorient or relocate the receiving antenna
- Increase the separation between the equipment and receiver
- Connect the equipment into an outlet on a circuit different from that to which the receiver is connected
- Consult the dealer or an experienced radio/TV technician for help

This device complies with Part 15 of the FCC Rules. Operation is subject to the following two conditions: (1) this device may not cause harmful interference, and (2) this device must accept any interference received, including interference that may cause undesired operation.

Caution

- To comply with FCC RF exposure compliance requirements, a separation distance of at least 20 cm must be maintained between the antenna of this device and all persons.
- This Transmitter must not be co-located or operating in conjunction with any other antenna or transmitter.
- Changes or modifications to this unit not expressly approved by the party responsible for compliance could void the user authority to operate the equipment.