



Remove All Sharp Edges
Do Not Scale
If In Doubt - Ask!

Technical Information

Safe working load = 300Kg
Maximum threshold height = 1000mm
Lift speed = 20mm/sec
Ramp gradient = 1:6
Power supply = 230Vac 50Hz single phase & earth
Lift operating voltage = 24Vdc
Battery Powered raise and lowering
Manual emergency lowering
Hydraulic drive
Total lift unladen weight = 200Kg
Suitable for internal and external use

A turning circle of diameter 1500mm is recommended at the entrance and exit points of the lift.

A minimum of 2m is required above the first floor level.

	LR800	LR900	LR1100
Useable Platform Width	800	900	1100
Useable Platform Length	1450	1450	1450
Lift External Width Dimension	1004	1104	1304
Recommended Minimum Width to fit the Lift	1304	1404	1604

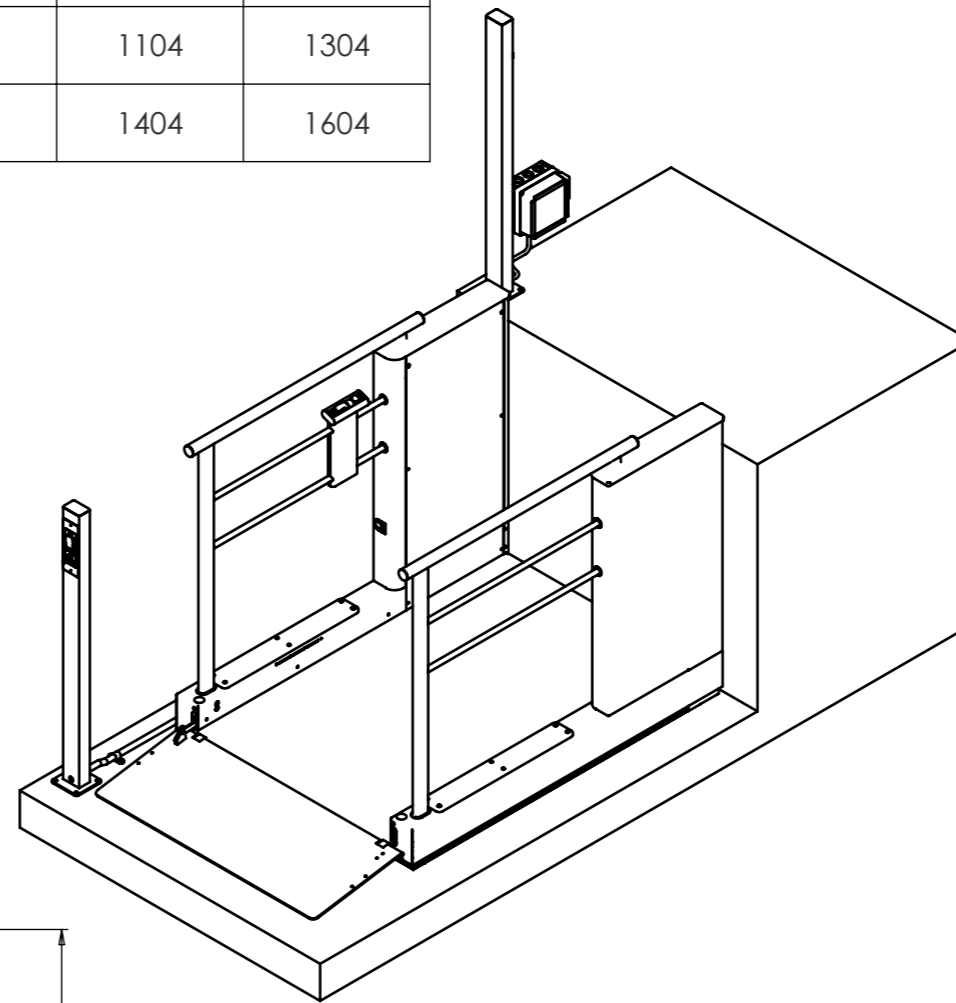

Lift power supply unit (PSU)

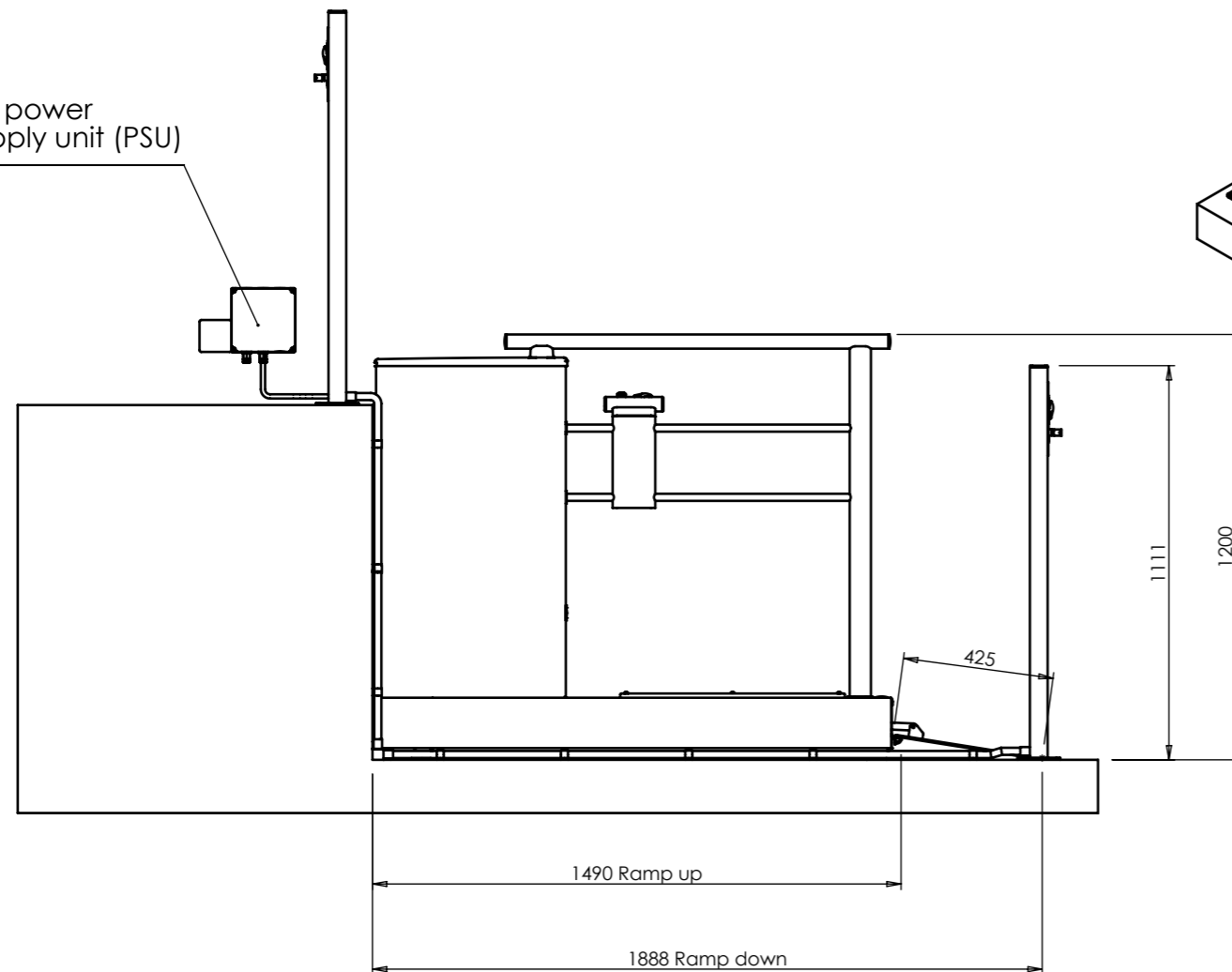

Notes - Lift Clearances

Please note that it is not recommended the LR is fitted any closer than 70mm to any continuous surface.

See Handrail Detail 'A' Below

Side panel (full infills) are available, these can overcome certain hazards.
e.g. Dwarf walls at the ground floor, which are below 1200mm high.

Each site presents different risks, these must be assessed and addressed accordingly.

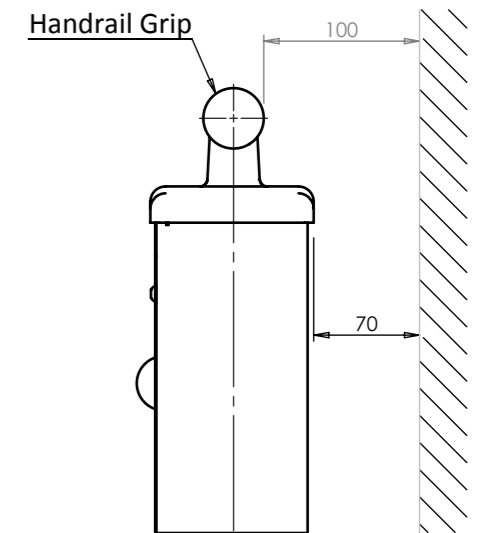

Detail 'A'

ALTERATION	ECO	INITIALS	DATE	REV
Text Updated	1480	WP	28/08/2013	F



Wessex Lift Company Limited,
Budds Lane, Romsey, Hampshire,
SO51 0HA

THIS DRAWING IS THE PROPERTY OF WESSEX LIFT COMPANY LIMITED, AND MAY NOT BE PUBLISHED, REPRODUCED OR USED FOR MANUFACTURE WITHOUT THE EXPRESS PERMISSION OF THE OWNERS IN WRITING

(PDM Issue 1 @ 28/11/2012)

All dimensions are in mm unless otherwise stated.

TOLERANCES unless otherwise stated:

Decimal Places:
X = ±1
X.X = ±0.25
X.XX = ±0.13
ANGULAR: ±0.5°
Thread ISO Coarse Class 6
Hole sizes = H11

DRAWN BY:	WP	DATE:	15/10/2009
MATERIAL:	Refer to details		
FINISH:	N/A		
WEIGHT:	32208.93		
SCALE:	1:50	Sheet Size A3	

TITLE:
**LR Lift Specification
No Gate**

DWG NO:	LR00 7000
Status:	ECO Release
SHEET 1 of 5	



Remove All Sharp Edges
Do Not Scale
If In Doubt - Ask!

Technical Information

Safe working load = 300Kg
Maximum threshold height = 1000mm
Lift speed = 20mm/sec
Ramp gradient = 1:6
Power supply = 230Vac 50Hz single phase & earth
Lift operating voltage = 24Vdc
Battery Powered raise and lowering
Manual emergency lowering
Hydraulic drive
Total lift unladen weight = 200Kg
Suitable for internal and external use

A turning circle of diameter 1500mm is recommended at the entrance and exit points of the lift.

A minimum of 2m is required above the first floor level.

	LR800	LR900	LR1100
Useable Platform Width Dimension 'Y'	800	900	1100
Useable Platform Length	1450	1450	1450
Lift External Width Dimension 'W'	1004	1104	1304
Recommended Minimum Width Dimension 'X'	1304	1404	1604
Gate Frame Width Dimension 'Z'	1015	1115	1315
Gate Open Dimension 'V'	844	944	1144

UPPER LEVEL GATE OPTION DETAILS

Must have minimum of 250mm threshold height when fitting a gate.

The gate post will house the upper level call controls.

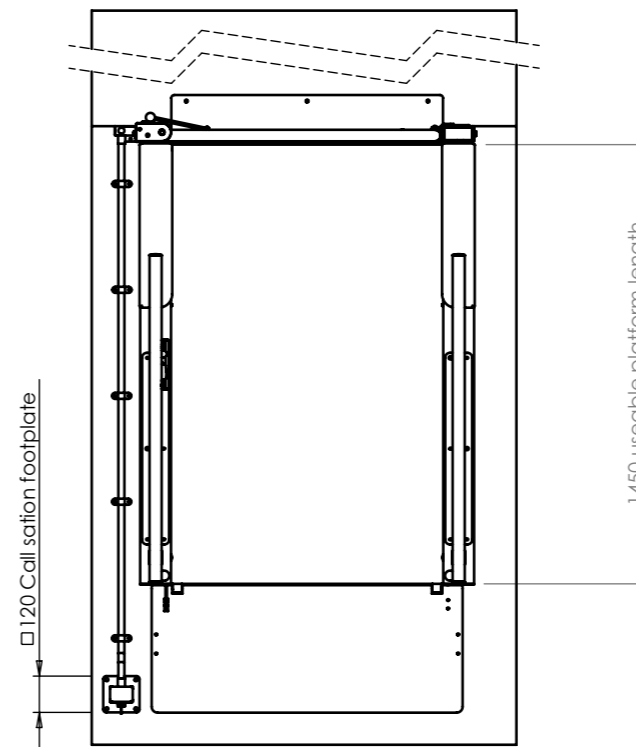

Notes - Lift Clearances

Please note that it is not recommended the LR is fitted any closer than 70mm to any continuous surface.

See Handrail Detail 'A' Below

Side panel (full infills) are available, these can overcome certain hazards. e.g. Dwarf walls at the ground floor, which are below 1200mm high.

Each site presents different risks, these must be assessed and addressed accordingly.

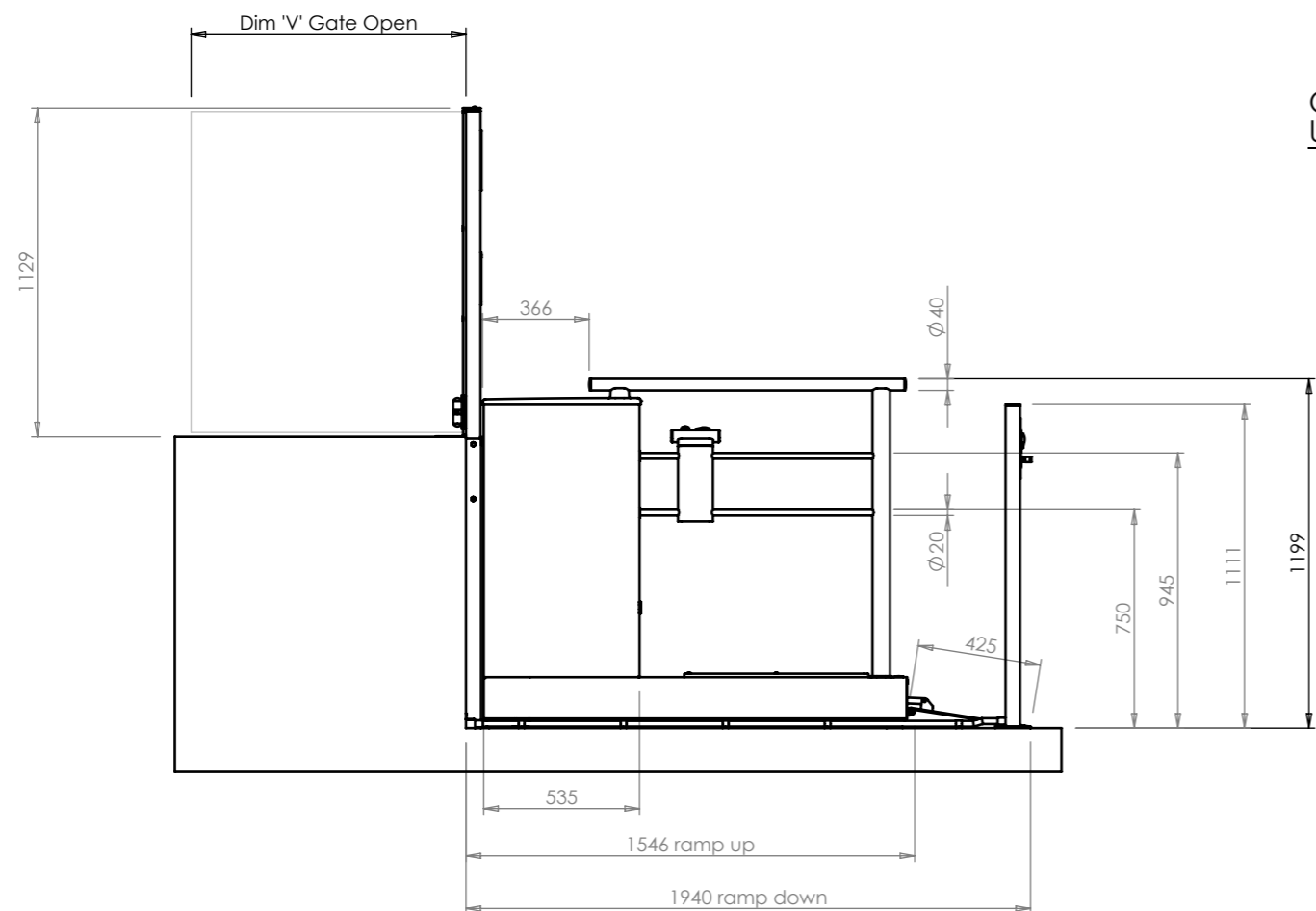
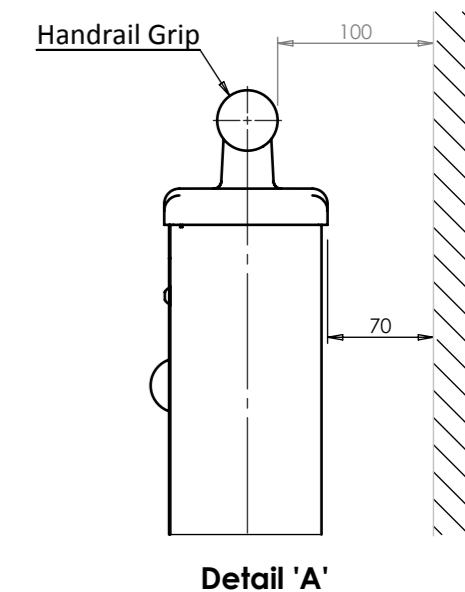

Optional Extra Upper level gate

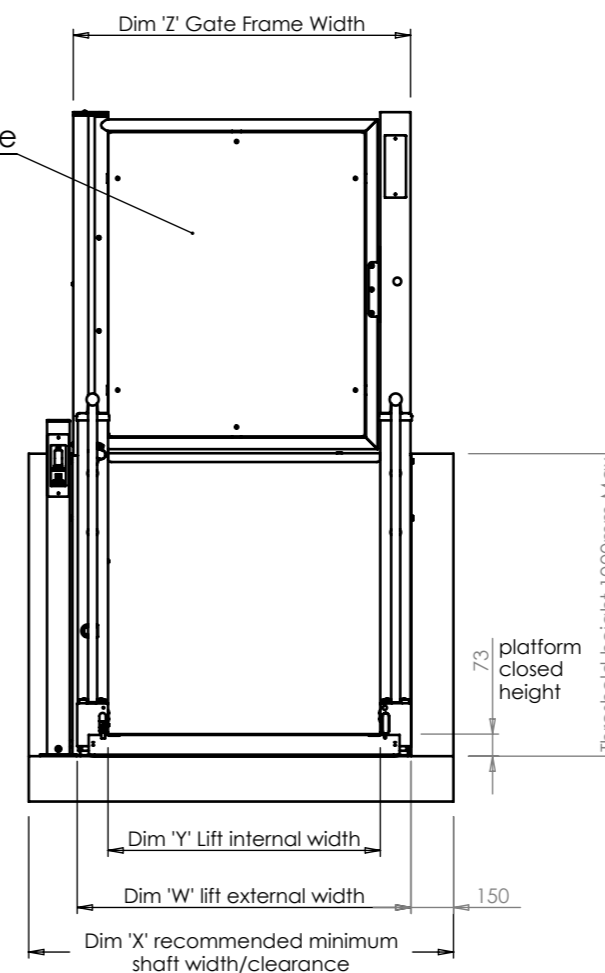

ALTERATION	ECO	INITIALS	DATE	REV
Text Updated	1480	WP	28/08/2013	F



Wessex Lift Company Limited,
Budds Lane, Romsey, Hampshire,
SO51 0HA

THIS DRAWING IS THE PROPERTY OF WESSEX LIFT COMPANY LIMITED, AND MAY NOT BE PUBLISHED, REPRODUCED OR USED FOR MANUFACTURE WITHOUT THE EXPRESS PERMISSION OF THE OWNERS IN WRITING

(PDM Issue 1 @ 28/11/2012)

All dimensions are in mm unless otherwise stated.

TOLERANCES unless otherwise stated:

Decimal Places:
X = ±1
X.X = ±0.25
X.XX = ±0.13
ANGULAR: ±0.5°
Thread ISO Coarse Class 6
Hole sizes = H11

DRAWN BY:	WP	DATE:	22/03/2011
MATERIAL:	Material <not specified>		
FINISH:	N/A		
WEIGHT:	16239812.21		
SCALE:	1:25	Sheet Size A3	

TITLE:
**LR Lift Specification
with Threshold Gate**

DWG NO:	LR00 7000
Status:	ECO Release
SHEET 2 of 5	



Remove All Sharp Edges
Do Not Scale
If In Doubt - Ask!

Upper call controls are usually fitted to the gate posts when a gate option is picked, unless otherwise stated.

The call stations may be fitted either side of the lift.

The lifts power supply unit may be fitted anywhere outside of the lifts footprint, within 12m. It must always remain easily accessible.

If fitting concealed conduit a minimum diameter of 40mm is recommended fitted with draw wires.

Power Supply to the Lift:

LR800 Standard duty requirement: 230Vac 50Hz SP&N 13A Fused Spur. Fused at 5 Amps
May be wired either from adjacent ring main or with a 13A plug into ring main. (domestic installation specification).

LR900/LR1100 Heavy duty requirement: 230Vac 50Hz SP&N 13A Fused Spur. Fused at 10 Amps
May be wired either from adjacent ring main or with a 13A plug into ring main. (domestic installation specification).

For public access it is recommended a lockable isolator is used. Must comply with the latest IEE regulations.

Lift power supply unit (PSU).
LR800 Standard duty size = 130x130x100 deep
LR900/1100 Heavy Duty size = 180x180x125 deep

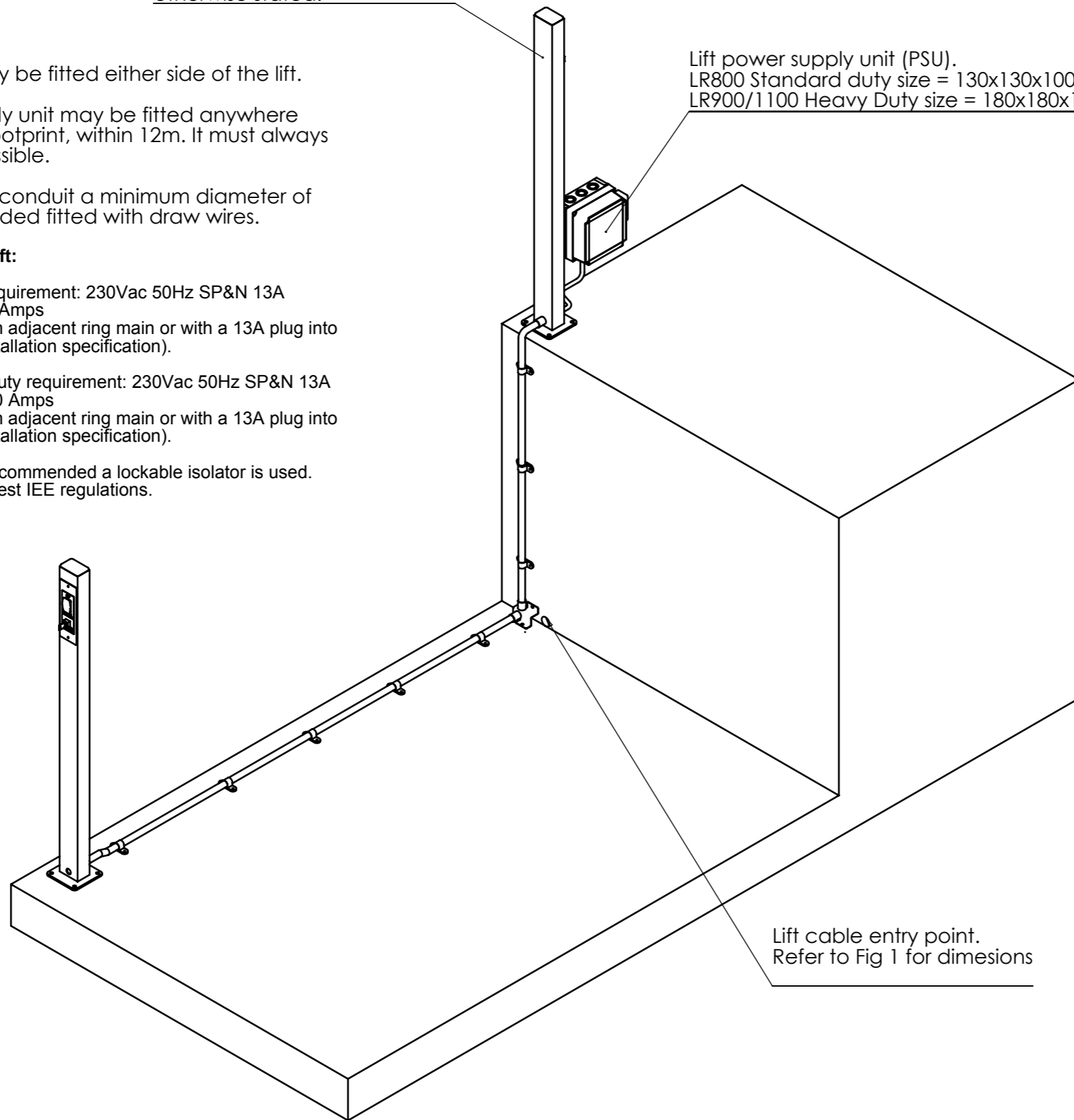

Lift cable entry point.
Refer to Fig 1 for dimesions

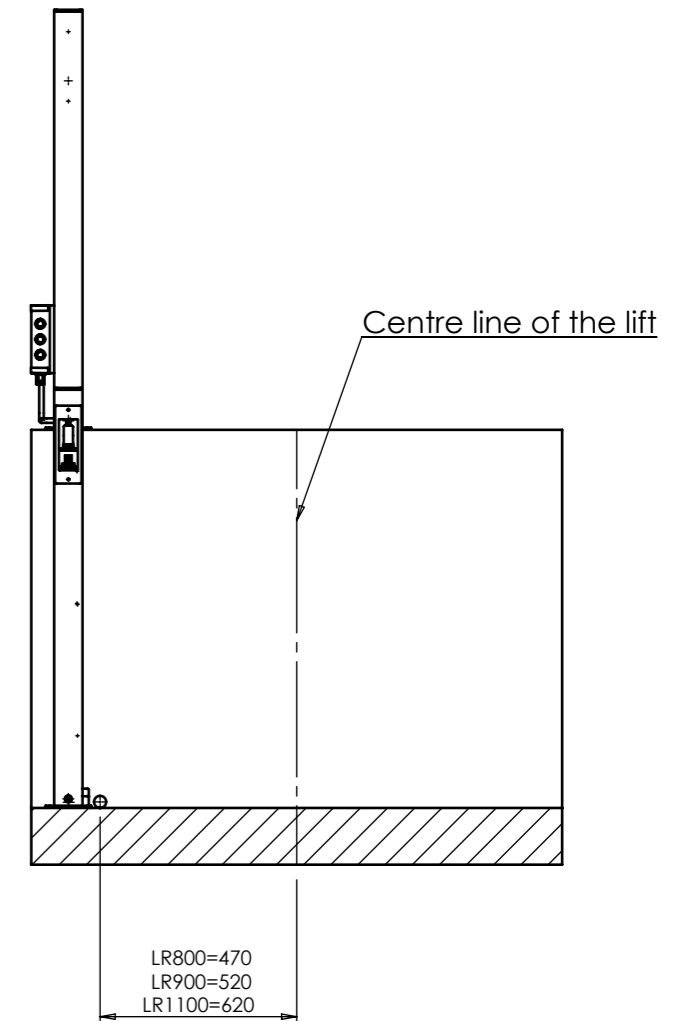

Fig 1
Front view of lift threshold face.

All the lift cables enter the lift at the LH corner hard against the threshold wall.

The cable from the PSU is a 12mm OD armoured cable.

The cables from the call stations are 7 core dia 7.5mm. (one upper and one lower call station).

Note if a gate is fitted, the upper call station will be integral with the gate post, and no conduit to the upper call station is required.

ALTERATION		ECO	INITIALS	DATE	REV
Sheets 1&2 Ammended		1480	WP	28/08/2013	F



Wessex Lift Company Limited,
Budds Lane, Romsey, Hampshire,
SO51 0HA

THIS DRAWING IS THE PROPERTY OF WESSEX LIFT COMPANY LIMITED, AND MAY NOT BE PUBLISHED REPRODUCED OR USED FOR MANUFACTURE WITHOUT THE EXPRESS PERMISSION OF THE OWNERS IN WRITING

(PDM Issue 1 @ 28/11/2012)

All dimensions are in mm unless otherwise stated.

TOLERANCES unless otherwise stated:

Decimal Places:
X = ±1
X.X = ±0.25
X.XX = ±0.13
ANGULAR: ±0.5°
Thread ISO Coarse Class 6
Hole sizes = H11

DRAWN BY:	WP	DATE:	15/10/2009
MATERIAL:	Material <not specified>		
FINISH:	N/A		
WEIGHT:	15951906.35		
SCALE:	1:20	Sheet Size A3	

TITLE:
**LR Lift Specification
Wiring Details**

DWG NO:	LR00 7000
Status:	ECO Release
SHEET 3 of 5	



Remove All Sharp Edges
Do Not Scale
If In Doubt - Ask!

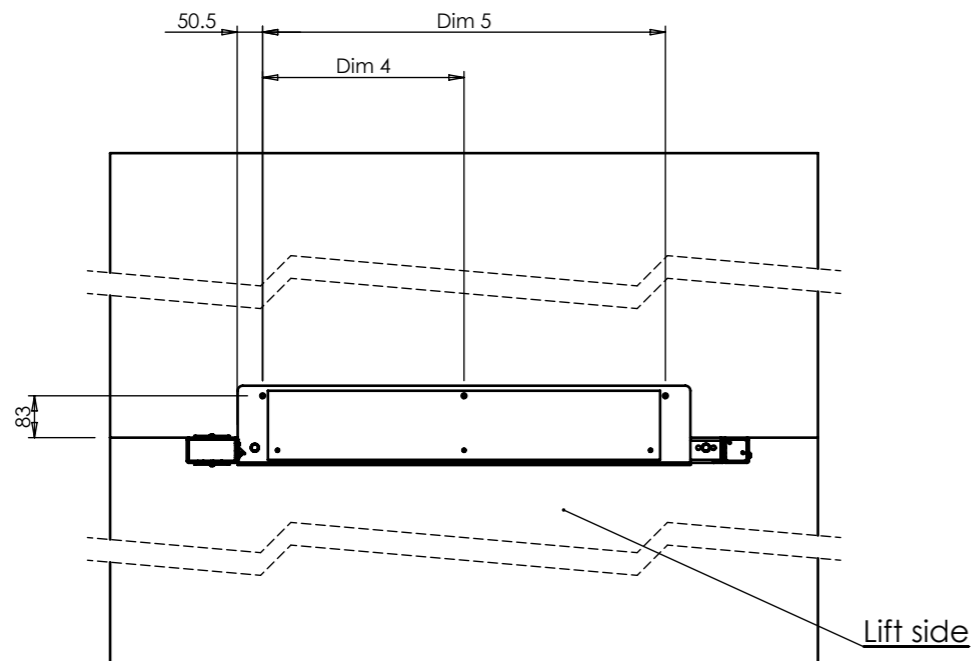

LH Threshold Gate Fixing Centres

Please note the threshold gate is handed, by looking at the hinge side of the gate frame from the upper level.

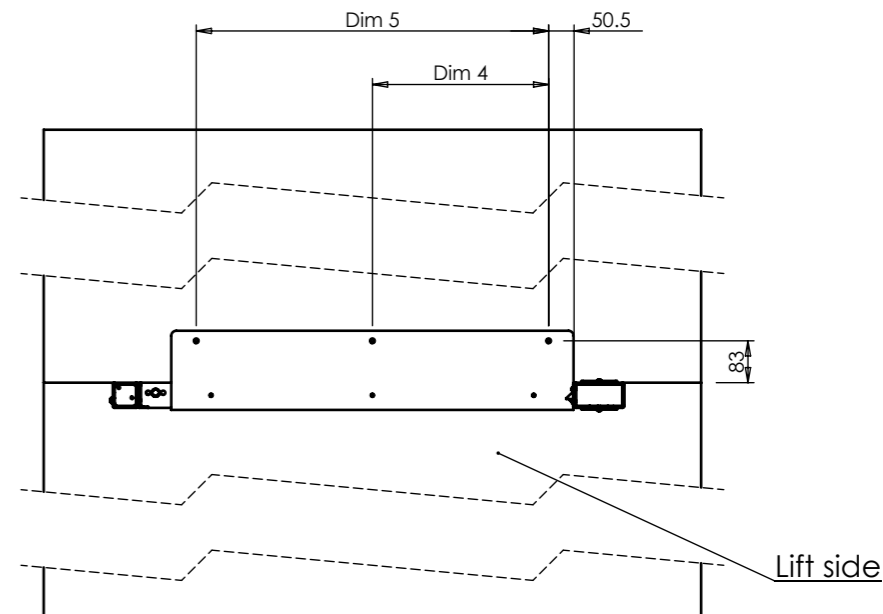

RH Threshold Gate Fixing Centres

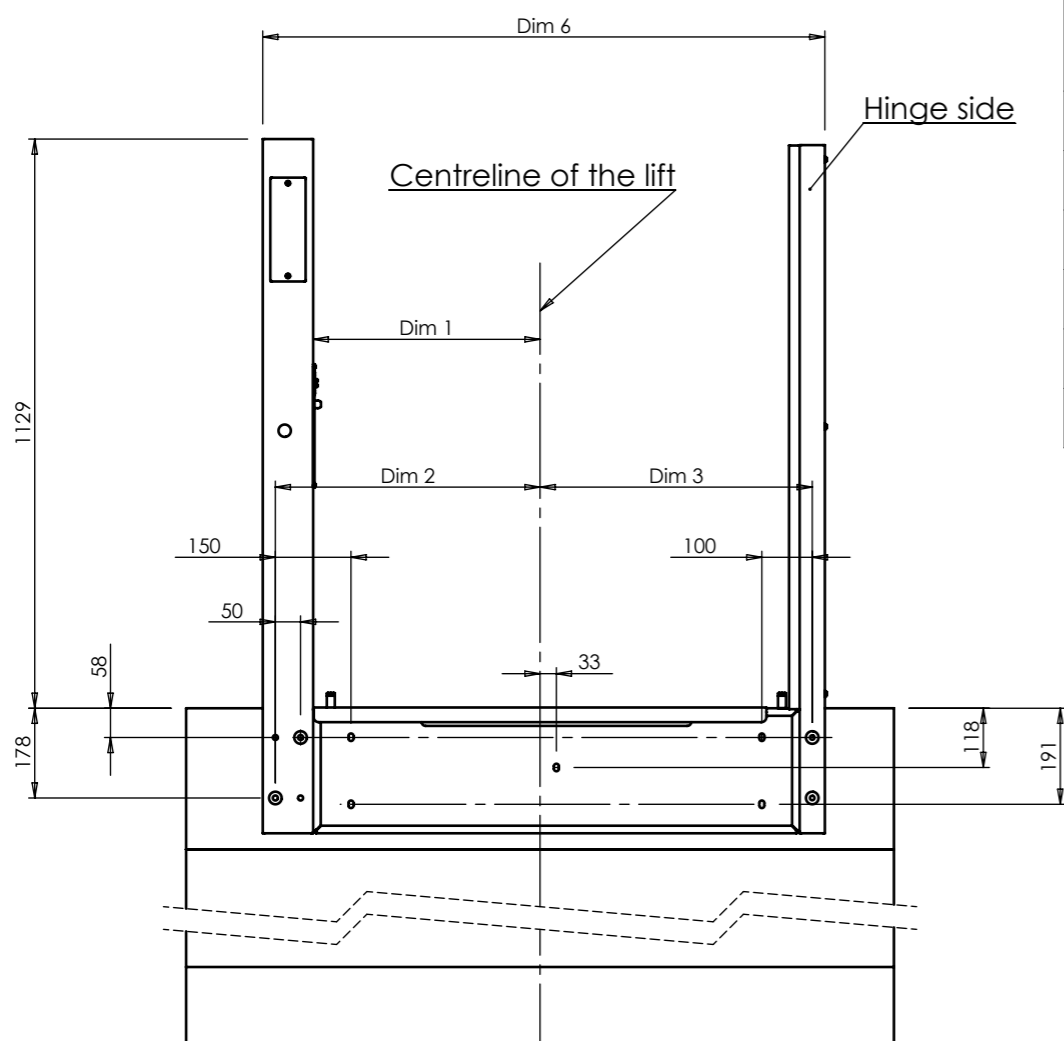

	LR800	LR900	LR1100
Dim 1	400	450	550
Dim 2	475	525	625
Dim 3	490	540	640
Dim 4	349.5	399.5	499.5
Dim 5	699	799	999
Dim 6	1015	1115	1315

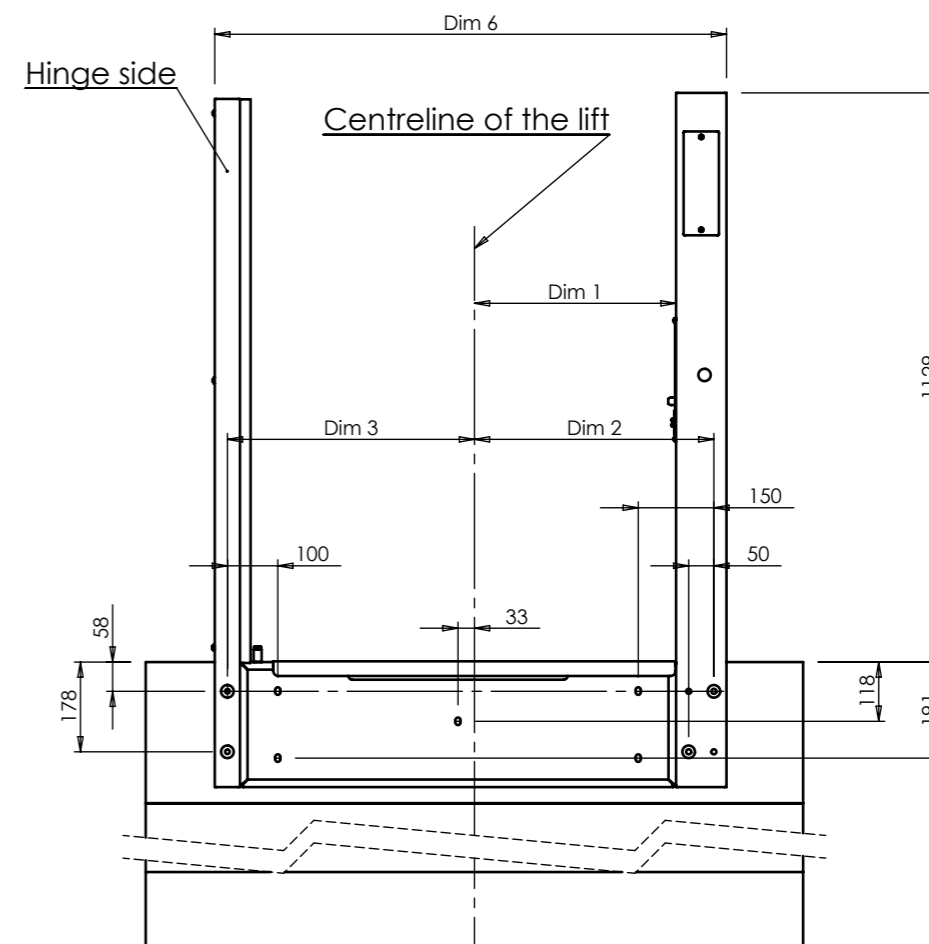

ALTERATION	ECO	INITIALS	DATE	REV
Sheets 1&2 Ammended	1480	WP	28/08/2013	F



Wessex Lift Company Limited,
Budds Lane, Romsey, Hampshire,
SO51 0HA

THIS DRAWING IS THE PROPERTY OF WESSEX LIFT COMPANY LIMITED, AND MAY NOT BE PUBLISHED REPRODUCED OR USED FOR MANUFACTURE WITHOUT THE EXPRESS PERMISSION OF THE OWNERS IN WRITING

(PDM Issue 1 @ 28/11/2012)

All dimensions are in mm unless otherwise stated.

TOLERANCES unless otherwise stated:

Decimal Places:

X = ±1

X.X = ±0.25

X.XX = ±0.13

ANGULAR: ±0.5°

Thread ISO Coarse Class 6

Hole sizes = H11

DRAWN BY:	WP	DATE:	02/04/2007
MATERIAL:	N/A	TITLE:	
FINISH:	N/A		
WEIGHT:	2060.53		
SCALE:	1:50	Sheet Size	A3

**LR Lift Specification
Gate Frame Fixings**

DWG NO:	LR00 7000
Status:	ECO Release
	SHEET 4 of 5



Third Angle Projection

Remove All Sharp Edges
Do Not Scale
If In Doubt - Ask!

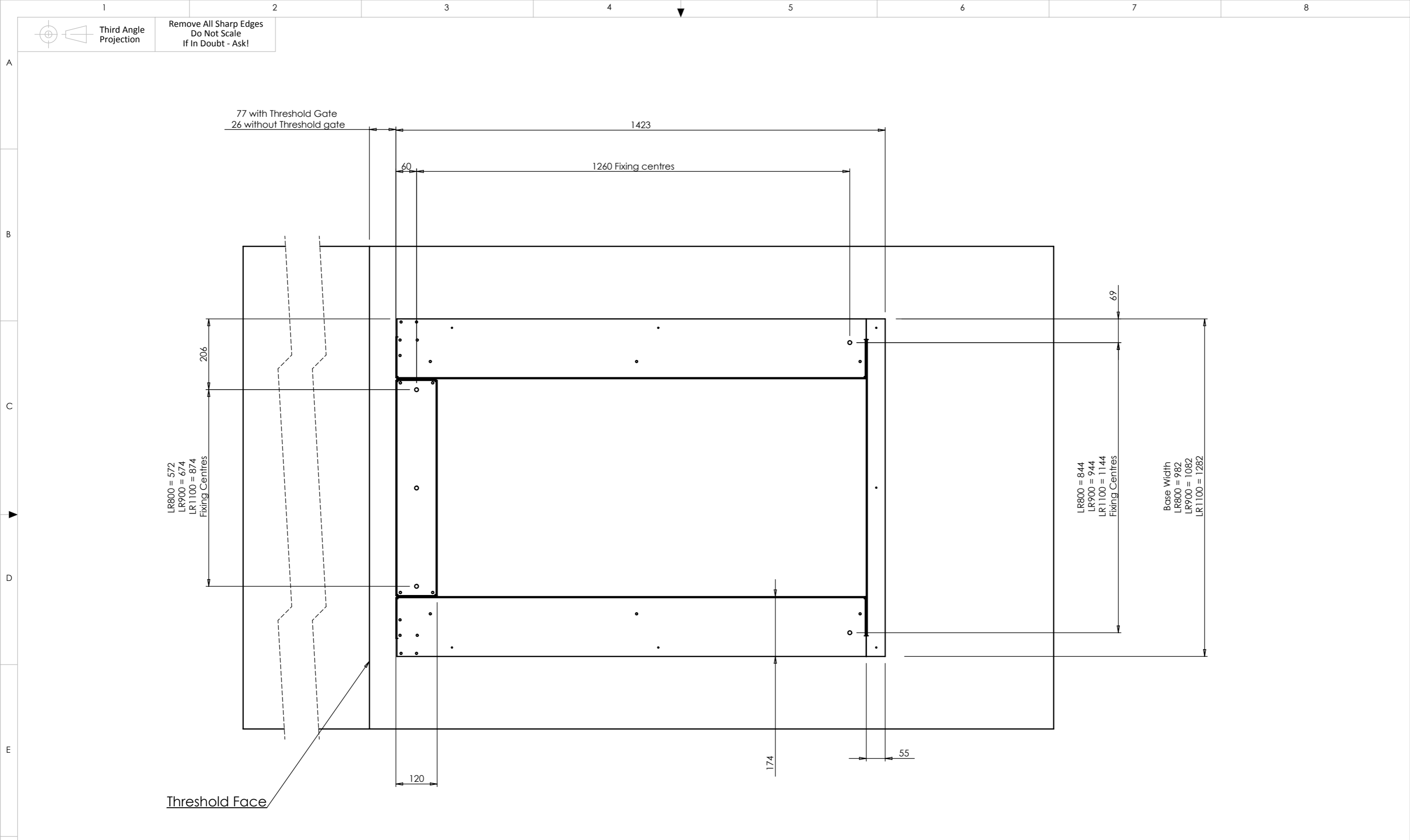

ALTERATION			
ECO	INITIALS	DATE	REV
1480	WP	28/08/2013	F

Wessex Lift Company Limited,
Budds Lane, Romsey, Hampshire,
SO51 0HA

THIS DRAWING IS THE PROPERTY OF WESSEX LIFT COMPANY LIMITED, AND MAY NOT BE PUBLISHED, REPRODUCED OR USED FOR MANUFACTURE WITHOUT THE EXPRESS PERMISSION OF THE OWNERS IN WRITING

SPECIALISTS IN LOW RISE LIFTING SOLUTIONS

(PDM Issue 1 @ 28/11/2012)

All dimensions are in mm unless otherwise stated.
TOLERANCES unless otherwise stated:
Decimal Places:
X = ±1
X.X = ±0.25
X.XX = ±0.13
ANGULAR: ±0.5°
Thread ISO Coarse Class 6
Hole sizes = H11

DRAWN BY:	WP	DATE:	28/03/2011
MATERIAL:	N/A		
FINISH:	N/A		
WEIGHT:	2049.77		
SCALE:	1:50		

TITLE:
**LR Lift Specification
Base Dimensions**

Sheet Size A3

DWG NO:
LR00 7000

Status: ECO Release

SHEET 5 of 5